



# Tucson Realty & Trust Co.

Southwest Expertise, Global Capability

333 N. Wilmot Rd., Ste 340

Tucson, AZ 85711

520-577-7000

[www.tucsonrealty.com](http://www.tucsonrealty.com)

FOR LEASE



## 3525 S. Palo Verde Rd

3300 SF Available for Lease

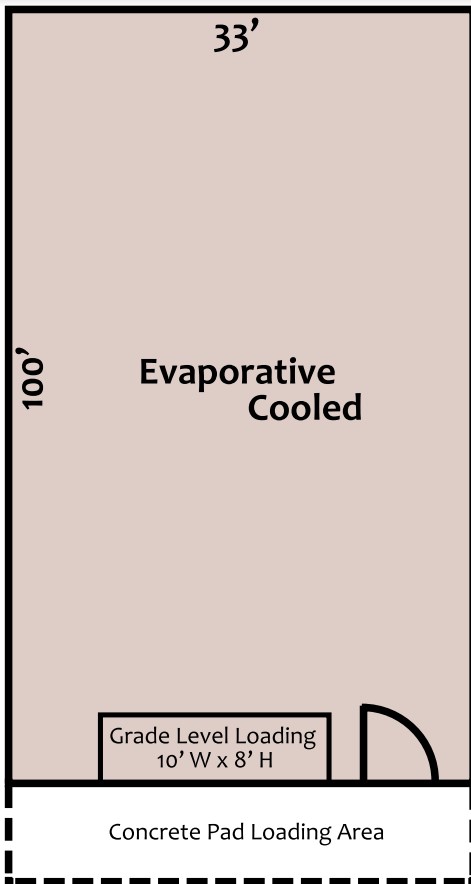

- Asking \$1650 a month Gross
- Entrance door and roll up to rear of building
- Approximately 3000 +/- sf of fenced yard storage
- Just north of Ajo
- Zoned CI-2, County

Exclusively Represented by:  
**Tucson Realty & Trust Co.**  
 Management Services, L.L.C.

**Chuck Blacher**

Cell 520-360-7800

**Tucson Realty & Trust Co.**

**Hank Amos**

Office 520-577-7000

Information contained herein has been obtained from the owner of the property or other source that we deem reliable. We have no reason to doubt its accuracy, but do not guarantee it.



# Tucson Realty & Trust Co.

Southwest Expertise, Global Capability

333 N. Wilmot Rd., Ste 340

Tucson, AZ 85711

520-577-7000

[www.tucsonrealty.com](http://www.tucsonrealty.com)

FOR LEASE

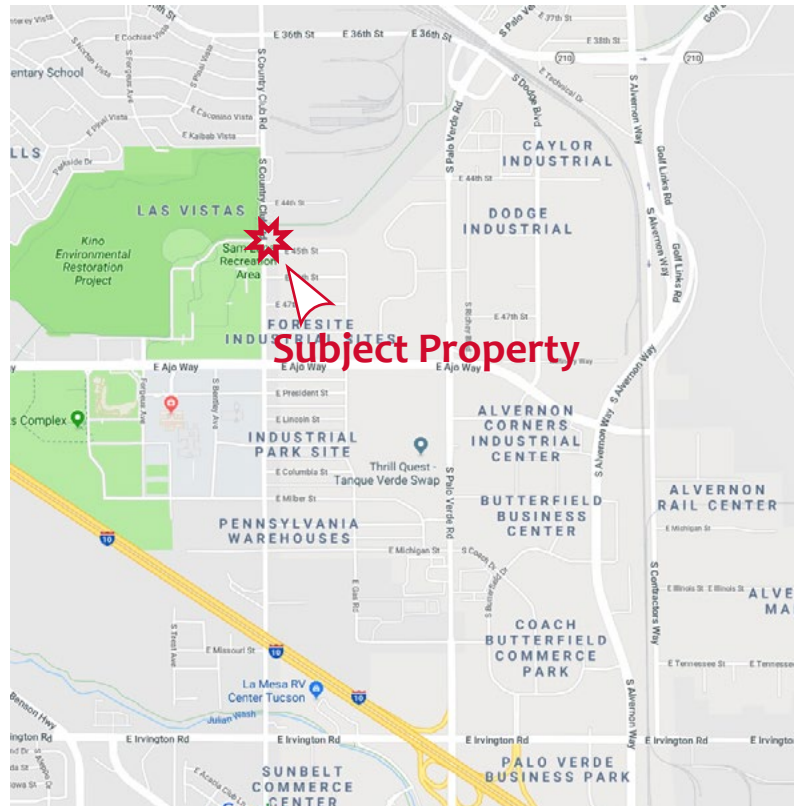

Information contained herein has been obtained from the owner of the property or other source that we deem reliable. We have no reason to doubt its accuracy, but do not guarantee it.