



Tucson Realty & Trust Co.

Southwest Expertise, Global Capability

333 N. Wilmot Rd., Ste 340

Tucson, AZ 85711

520-577-7000

www.tucsonrealty.com

FOR LEASE

4525 E Skyline Drive



Office Available in Fabulous Foothills location between La Paloma and Skyline Country Club!

Tucson Realty & Trust Co.
Management Services, L.L.C.

Sonia McKinney

Office 520-327-0009

Tucson Realty & Trust Co

Doug Richardson

Cell 520-205-2718

Office 520-577-7000

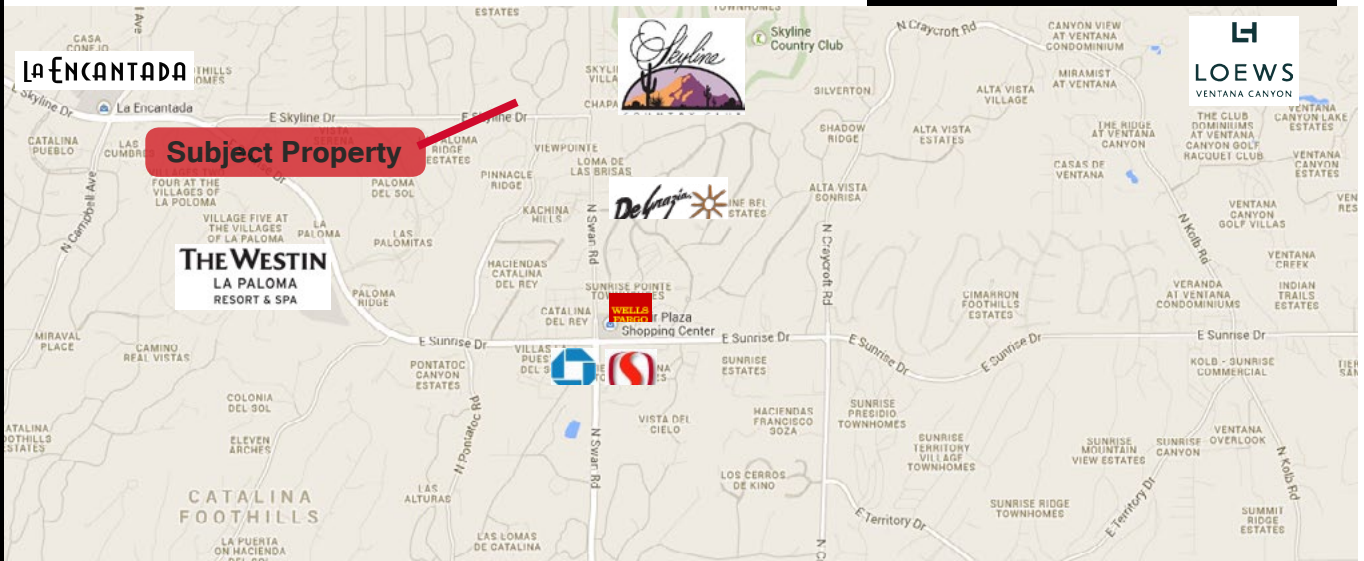

Information contained herein has been obtained from the owner of the property or other source that we deem reliable. We have no reason to doubt its accuracy, but do not guarantee it.



Tucson Realty & Trust Co.

Southwest Expertise, Global Capability

333 N. Wilmot Rd., Ste 340

Tucson, AZ 85711

520-577-7000

www.tucsonrealty.com

FOR LEASE

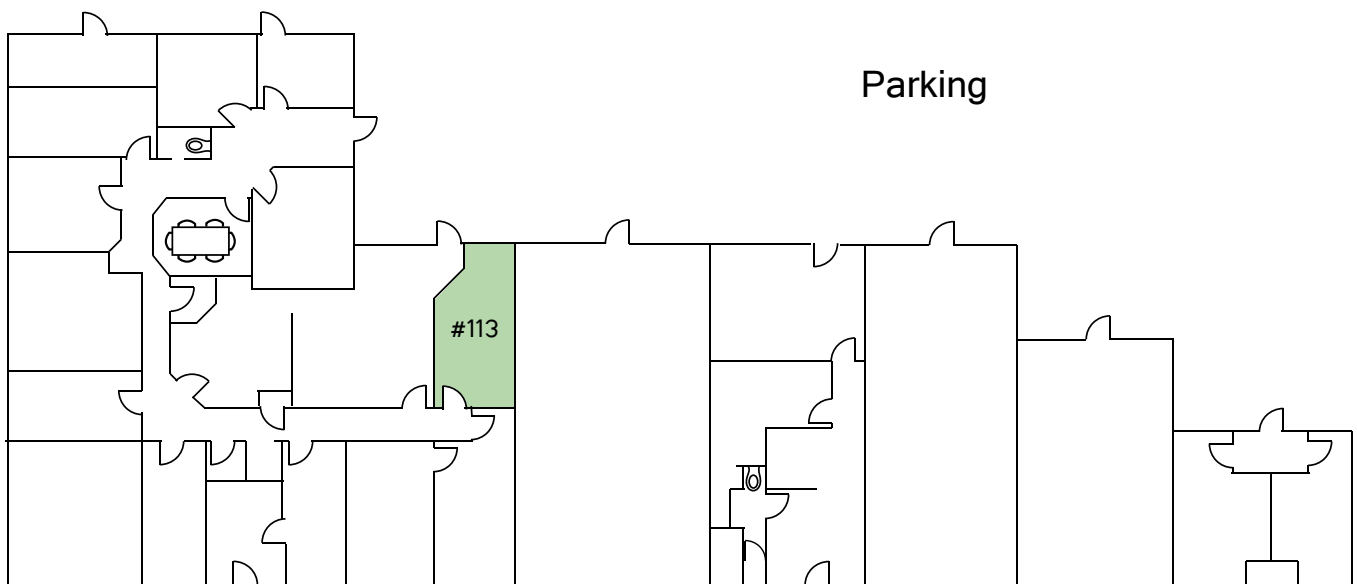

Available January 1, 2018!

Suite	Available Square Feet	Rent	Rent Type
113	258	\$435 per month	Full Service

Tucson Realty & Trust Co.
Management Services, L.L.C.

Sonia McKinney

Office 520-327-0009

Tucson Realty & Trust Co

Doug Richardson

Cell 520-205-2718

Office 520-577-7000

Information contained herein has been obtained from the owner of the property or other source that we deem reliable. We have no reason to doubt its accuracy, but do not guarantee it.